

Chain Swing Nest with slide RH180KB - Blue (1m)

Product type RH-180KB-10

Basic information

Age category	2 - 15 years
Minimum area	8,4 m x 7,8 m
Equipment measurements	5,4 m x 2,94 m x 1,77 m
Free fall height:	1 m
Load capacity:	486 kg
Max. number of users:	9
Fall zone: EN 1177	null
Designation:	exterior
Availability of spare parts:	supplied by the
Certificate of Compliance:	ČSN EN 1176 - 1, 2

Material

Metal parts - structural steel
 Slide - fiberglass
 Plastic parts - HDPE
 Platform - waterproof plywood
 Suspension ropes NEST - polypropylene with inner steel core
 Rope seat RUN - high-strength fiber polypropylene

Finish

null
 null

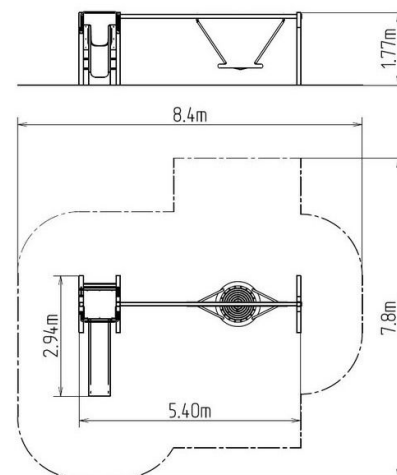

Description

The load-bearing structure of the double-shaft is made of structural steel, which is protected against corrosion by zinc coating, which results in a very significant extension of the life of the play element and fired paint KOMAXIT according to RAL. These structures are embedded in a concrete bed. All other metal elements are also treated with galvanizing and fired with KOMAXIT RAL.

The slide is made of fiberglass. The chute front is made of high-quality HDPE (high-pressure, full-colored polyethylene, which is characterized by high color stability, UV resistance and especially safety because it is brittle and there is no risk of injury to children by sharp debris). The "Nest" seat is made of high-strength fiber polypropylene rope. The suspension ropes are made of HERKULES (16 mm polypropylene rope with internal steel core). The podesta is made of waterproof plywood for outdoor use or HDPE on customer's request. All fasteners are galvanized or stainless steel.

Equipment

1 seat "nest" (diameter 1 m), 1x slide, 1x metal beam (galvanized), 1x ladder outlet with metal treads. There are three color options to choose from - brown, blue and red and four color variations - blue, red, green and yellow.