

Twin chain swing with a slide RH250D (f.h. 1,5 m)

Product type RH-250D-15

Basic information

Age category	2 - 15 years
Minimum area	8,4 m x 8,5 m
Equipment measurements	5,4 m x 3,72 m x 2,24 m
Free fall height:	1,5 m
Max. number of users:	6
Fall zone: EN 1177	null, 52,5 m ²
Certificate of Compliance:	ČSN EN 1176-1 ed.2 +A1:2024 ČSN EN 1176-2 ed.2:2018 ČSN EN 1176-3 ed.2:2018

Material

Wooden units - thick glued wooden supports
Metal units - structural steel
Plastic units - HDPE
Slide - fibreglass

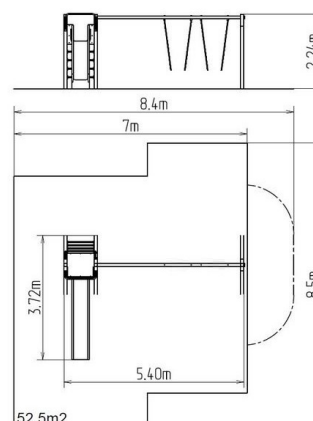

Finish

null
Duplex powder coated with coat curing
Hot-dip galvanizing

Description

The swing's support structure is made from thick glued wooden supports. This solution ensures maximum protection against cracking, which is common for products made from solid wood. The wooden supports are impregnated and coated with a triple layer of lacquer, which meets the terms and conditions of the EN71/3 Standard (safe for children's toys). The structures are anchored into the ground in steel plates, which are protected against corrosion by hot-dip galvanizing and fixed in a concrete bed. The anchors are fastened to the play unit with bolts and their structure ensures that they are not in direct contact with the ground.

The slide is made from fibreglass. The surface of the slide is made from high quality HDPE plastic (high density coloured polyethylene, which is characterised by high colour stability, UV resistance but mainly safety as it doesn't break and therefore there is no danger of injury to children by sharp fragments). The swings are hung on a metal girder using galvanized chains. The swing seat are steel, covered with a soft and comfortable rubber. The platform is made from HPL (High-pressure laminate, which is characterised by high colour stability and water resistance). All fastening material is galvanized or stainless steel.