

Twin chain swing RH220KW - brown (f.h. 1,5 m)

Product type RH-220KW-15

Basic information

Age category	2 - 15 years
Minimum area	8 m x 7,5 m
Equipment measurements	4,8 m x 1,75 m x 2,24 m
Free fall height:	1,5 m
Max. number of users:	6
Fall zone: EN 1177	null, 37,5 m ²
Certificate of Compliance:	

Material

Metal units - structural steel
 The "Bird's Nest" seat - polypropylene rope with heavy duty fibres
 The hanging ropes - polypropylene with a steel internal core

Finish

Duplex powder coated with coat curing
 Hot-dip galvanizing

Description

The support structure of the swing is made from structural steel, which is zinc coated and KOMAXIT powder coated according to the RAL colour chart and is fixed in a concrete bed.

The swings are hung on a metal girder using galvanized chains. The "Bird's Nest" seat is made from polypropylene rope with heavy duty fibres. The hanging ropes are made using HERKULES material (16 mm thick ropes made from polypropylene with a steel internal core). All fastening material is galvanized or stainless steel.

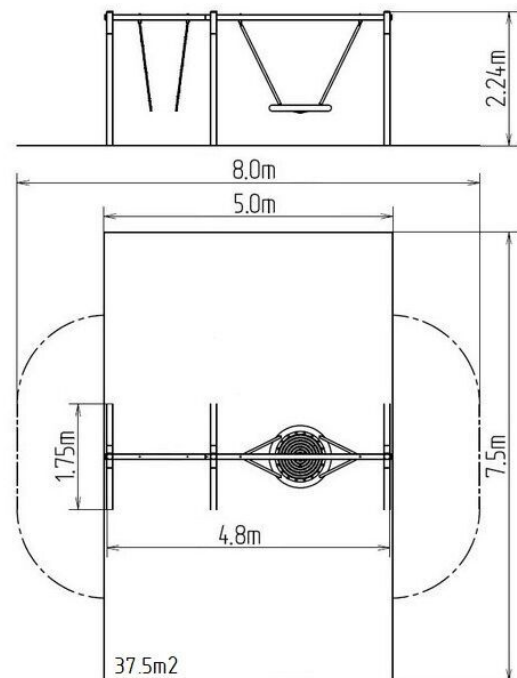

Equipment

We offer three color variants of the support structure - red, blue and brown.